

NOTICE OF INTENT TO HARVEST TIMBER

A Timber Harvesting Plan (Plan) or Amendment has been submitted to the California Department of Forestry & Fire Protection (CAL FIRE). CAL FIRE will be reviewing the proposed timber operation for compliance with State law and rules of the Board of Forestry and Fire Protection. The following briefly describes the proposed timber operation and where and how to get more information. In accordance with the timeline stated under Public Resources Code Section 4582.7, you may submit written public comments on the Plan or Amendment for CAL FIRE to consider.

This notice applies to (select one):

- New Timber Harvesting Plan
- Amendment Approved Timber Harvesting Plan

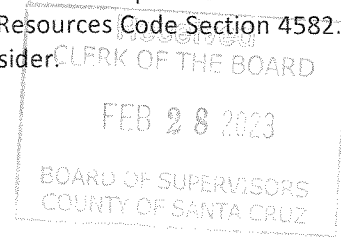

Applicant Information (Timberland Owner(s), Registered Professional Forester who prepared the plan and Plan Submitter should match those listed in the plan or amendment.)

1. The name(s) of the Timberland Owner(s) where timber operations are to occur: Lawrence W Holmes & Bronia Lewandowski

2. Registered Professional Forester who prepared the plan or amendment: Dennis Keith McCorkle, RPF 3120
 Registered Professional Forester Phone (optional): _____

3. The name of the Plan or Amendment Submitter: Lawrence W Holmes

Project Summary (County, legal description, acres proposed to be harvested and treatments to be used should match those listed in the plan or amendment.)

4. Location of the proposed timber operation (county, legal description, approximate direction & approximate distance of the timber operation from the nearest community or well-known landmark):
Santa Cruz County, T 9 S, R 2W, MDB&M, Section 20, Castle Rock Ridge Quadrangle.

The project boundaries are approximately 1 mile northeast of the town of Boulder Creek.

5. The name of, and distance from, the nearest perennial stream and major watercourse flowing through or downstream from the timber operation:
Hopkins Gulch Creek flows through the eastern portion of the Property Boundary, immediately adjacent to the harvest boundary.

6. Acres proposed to be harvested: 22 ac

7. The regeneration methods and intermediate treatments to be used:
Selection as per 14 CCR 913.8(a) and 14 CCR 926.25(a)(2)

POWERLINES: 14 CCR 1032.7(d)(10) & (e) (provide name and mailing addresses of the utilities for department distribution)

8. Overhead electrical power lines within the plan boundary? (except lines from transformers to service panels) Yes No

9 Overhead powerlines within 200 feet outside the plan boundary? Yes No

10. The approximate property lines have been flagged for review where truck roads, tractor roads or harvest areas are within 100 feet of the property line.

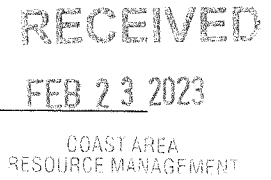

Public Information: The review times allowed for CAL FIRE to review the proposed timber operation are variable in length, but limited. To ensure CAL FIRE receives your comments please read the following:

The estimated earliest possible date CAL FIRE may **APPROVE** the Plan or Amendment is:

~~November 8, 2022~~ April 10, 2023

(This date is 15 calendar days from receipt of the Plan or Amendment by CAL FIRE, except in counties for which special rules have been adopted where the earliest date is 45 calendar days after receipt.)

NOTE: THE ESTIMATED EARLIEST APPROVAL DATE IS PROBABLY NOT THE ACTUAL APPROVAL DATE. Normally, a much longer period of time is available for public comment and preparation of CAL FIRE's responses to public comments. Please check with CAL FIRE, prior to the above listed date, to determine the actual date that the public comment period closes.

The public may review, or purchase a copy of, the Plan or Amendment at the CAL FIRE Review Team Office shown below. The cost to obtain a copy is 37 cents for each page, \$2.50 minimum per request. The cost to obtain a copy of this plan or amendment is: \$ 125.49 (to be completed by CAL FIRE upon receipt of plan).

Questions or concerns regarding this plan should be directed to the CAL FIRE Review Team Office shown below or emailed to SantaRosaPublicComment@fire.ca.gov for incorporation into an Official Response Document. Please include the plan number on all correspondence.

Forest Practice Program Manager
CAL FIRE
135 Ridgway Avenue
Santa Rosa, CA 95401
(707) 576-2959

The plan may be viewed online at <https://caltreesplans.resources.ca.gov/caltrees/> A map showing the approximate boundary of the THP area, a map legend, and a scale is attached to help in locating where the proposed timber operation is to occur.

For CAL FIRE Use Only

Timber Harvest Plan Number: 1-23-00024-SCR

Date of Receipt: _____

RECEIVED
FEB 23 2023
COAST AREA
RESOURCE MANAGEMENT

Location

Hopkins Gulch THP

LOCATED WITHIN PORTIONS OF SECTION 20, T. 9S, R. 2W,
MDB&M. USGS CASTLE ROCK RIDGE QUAD, SANTA CRUZ COUNTY.

RECEIVED

FEB 23 2023

COAST AREA
RESOURCE MANAGEMENT

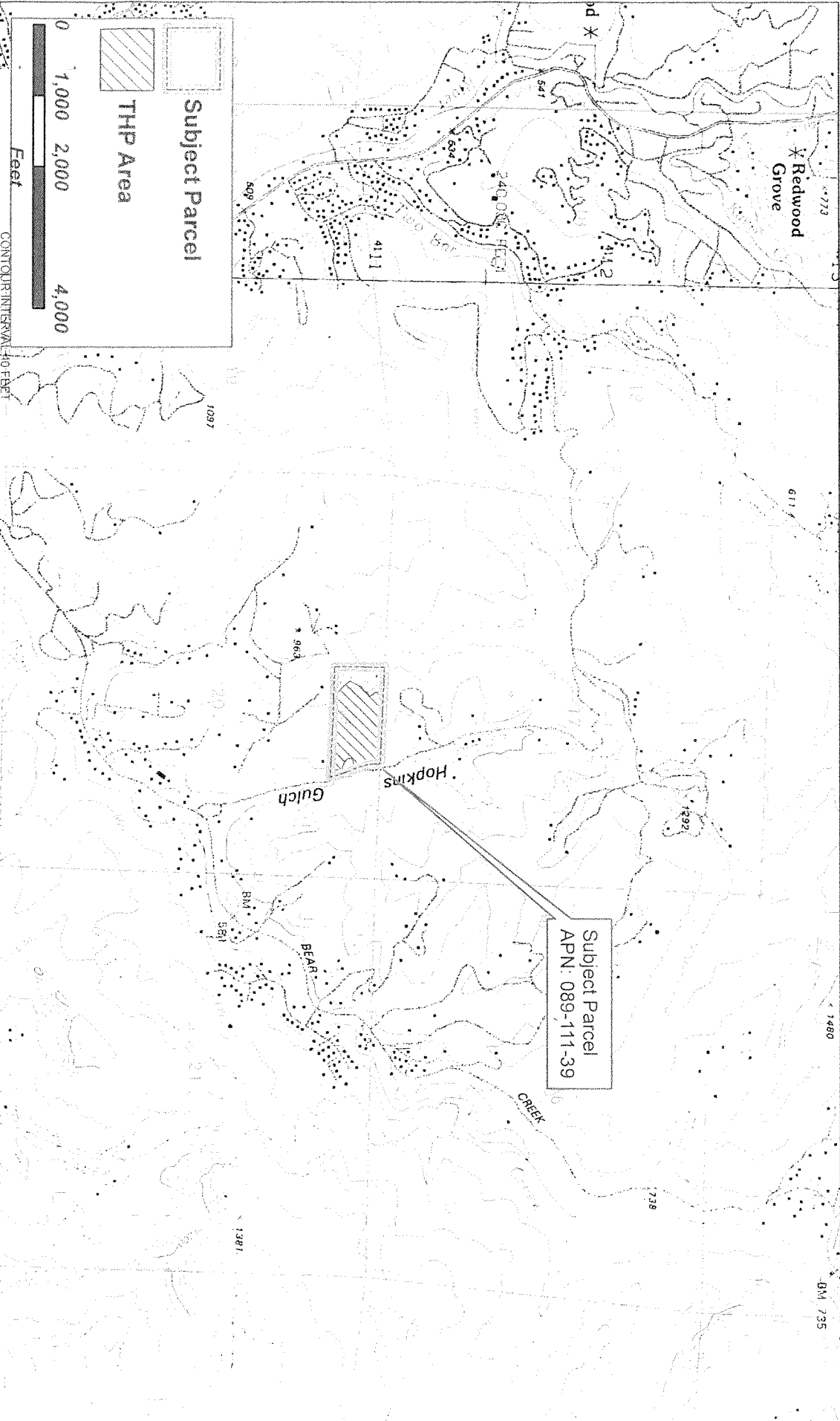
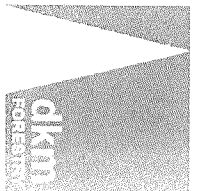



DEPARTMENT OF FORESTRY AND FIRE PROTECTION
San Mateo/Santa Cruz Unit
P.O. Drawer F-2
FELTON, CA 95018
(831) 335-6740
Website: www.fire.ca.gov



FACT SHEET ON TIMBER HARVEST REGULATION IN THE SANTA CRUZ MOUNTAINS

The enclosed Notice of Intent/Domestic Water Supply Inquiry ("Notice") is to inform you that either a Timber Harvesting Plan (THP) or a Nonindustrial Timber Management Plan (NTMP) is being prepared by a licensed forester for a private landowner whose property is near your property. **Although the forester has not yet submitted the THP/NTMP to the California Department of Forestry and Fire Protection (CAL FIRE) for review, this FACT SHEET will clarify both how and when you can obtain information about the proposed timber operation and how you may participate in the review process once the plan has been accepted for filing by CAL FIRE.**

The forester is required to mail a copy of the enclosed Notice to owners of property within 300 feet of the property where timber harvesting is proposed, to the owners of property adjoining private roads proposed to be used for trucking logs, and to other owners within 1000 feet downstream of the harvest boundary **prior to the THP/NTMP being submitted to CAL FIRE**. If helicopter operations are proposed in Santa Cruz County, the forester must notify additional people. **If after receiving this Notice you want more information about the THP/NTMP, you should wait approximately 15 calendar days to allow time for the THP/NTMP to arrive at the CAL FIRE Region Office and copies to be sent to CAL FIRE Felton before calling CAL FIRE. Prior to this time, CAL FIRE will not have any information about the THP/NTMP. You should contact the private forester as soon as possible if there are concerns which you believe should be included in the THP/NTMP.**

California's forest practice regulations, comprised of more than 1,000 regulations, are the most stringent and comprehensive to be found anywhere in the nation. They govern all aspects of the commercial harvest of forest products including the licensing of timber operators, preparation of timber harvesting plans, cutting intensity, harvest practices, road construction, erosion control, stream and watershed protection, hazard reduction, and fire protection. In addition, special local rules address such things as hours of work, traffic safety, and erosion control maintenance. Regulations for our area prohibit clear cutting. Only selective harvesting is permitted allowing just a portion of the standing timber to be cut.

The state's forest practice regulations are enforced by CAL FIRE. Enforcement includes the interdisciplinary environmental review by local (including water districts), state and federal agencies of all written harvest plans and inspection of both active and completed harvest operations to ensure compliance with the regulations. All harvest plans are prepared by a Registered Professional Forester (RPF), licensed to practice in the state, which also is responsible for on-the-ground supervision of harvest activities.

There are several ways you may learn more about this THP/NTMP and participate in its evaluation:

1. **Approximately 15 days from the date of the enclosed Notice, you may wish to confirm the availability of the THP/NTMP by calling the CAL FIRE Felton office at (831) 335-6740.**

April 1, 2022

RECEIVED
FEB 23 2023
COAST AREA
RESOURCE MANAGEMENT

2. Once CAL FIRE has received the THP/NTMP, you may obtain information, review the THP, or purchase a copy of it by writing CAL FIRE (P.O. Drawer F-2; Felton, CA 95018) or calling (831) 335-6740. You may also download a copy of the plan at our CALTREES site at:

<https://caltreesplans.resources.ca.gov/caltrees/Default.aspx>

You will need the THP number assigned to this plan to download a copy. That number can be obtained at the Felton office.

3. During the minimum 45 day review period, CAL FIRE may hold a public hearing on the harvest plan. **If a hearing is scheduled, you will be notified of the time and place in a separate mailing within a few weeks.** The purpose of the hearing is to give you an opportunity to provide any information, especially site-specific factors, you believe CAL FIRE should consider when evaluating the proposed plan. Examples include the location of water lines, uptakes, and landslides; local traffic patterns, etc. No decision regarding the THP/NTMP is made at this public hearing. CAL FIRE's responsibility is to document the concerns that are presented.
4. **If you are unable to attend a scheduled public hearing, please send us your comments in writing. *Written comments receive the same consideration as testimony received at the public hearing.*** Written comments should be addressed to Dominik Schwab at 135 Ridgway Avenue; Santa Rosa, CA 95401, where the official THP/NTMP documents are maintained, or sent via email to SantaRosaPublicComment@fire.ca.gov. The Santa Rosa office sends a copy of all public correspondence to the Felton office so that it can be considered during the review of the THP/NTMP.
5. Review of the THP/NTMP is carried out by CAL FIRE and representatives from the Department of Fish and Wildlife, Regional Water Quality Control Board, California Geological Survey, local water districts, and County Planning Department. The review includes a field inspection of the proposed operation called the Preharvest Inspection (PHI) and Preharvest Inspection Reports which discuss the THP/NTMP's provisions and make recommendations, where necessary, to ensure that the THP/NTMP conforms to the rules. These reports are discussed at the 2nd Review Team Meeting (chaired by CAL FIRE) at which time "Review Team Recommendations" are developed. These final recommendations, along with all CAL FIRE and other agency documents, and any public correspondence received at the Felton office, are submitted to CAL FIRE's regional office in Santa Rosa, where the Director's representative makes the final decision on the THP/NTMP. You may review these documents at the CALTREES site (see above) or at the CAL FIRE Felton office. Please call the CAL FIRE Felton office to confirm availability and any cost if you wish a printed copy from Felton.

If you have questions, please contact the RPF who will be submitting the THP/NTMP or contact a CAL FIRE forester at the Felton office (831) 335-6740.

Sincerely,

Nate Armstrong
Unit Chief
CAL FIRE San Mateo & Santa Cruz Unit

By: Richard Sampson
Division Chief-Resource Management
RPF #2422

RECEIVED

FEB 23 2023

CIVIC AREA
RESOURCE MANAGEMENT

April 1, 2022

